

General Notes:

This drawing shall be considered preliminary and should not be employed for construction unless it is labeled as "Issued for construction" Pencil Design shall not be held responsible for electrical, mechanical, telephone, structural or security system installations. All ideas, concepts, layouts as well as drawings and construction specifications remain the sole property of Pencil Design. The following has been developed for the requirements of the project specified below. No idea, layout, plan or drawing shall be employed or used as a de facto survey without the express written permission of Pencil Design. All plans issued by Pencil Design are to be read in conjunction with the plans of the other professionals and consultants. The builder shall provide all the materials specified in the contract documents and shall execute the construction according to the standards delineated in the municipal and national building codes as applicable. The builder shall verify all dimensions, measurements and specifications as well as the drawings and site conditions and report all errors, omissions or anomalies to Pencil Design. Prior to the commencement of the work. The sub-trades shall also signal errors, omissions or anomalies of their predecessors and report them to Pencil Design Inc. prior to the commencement of the work.

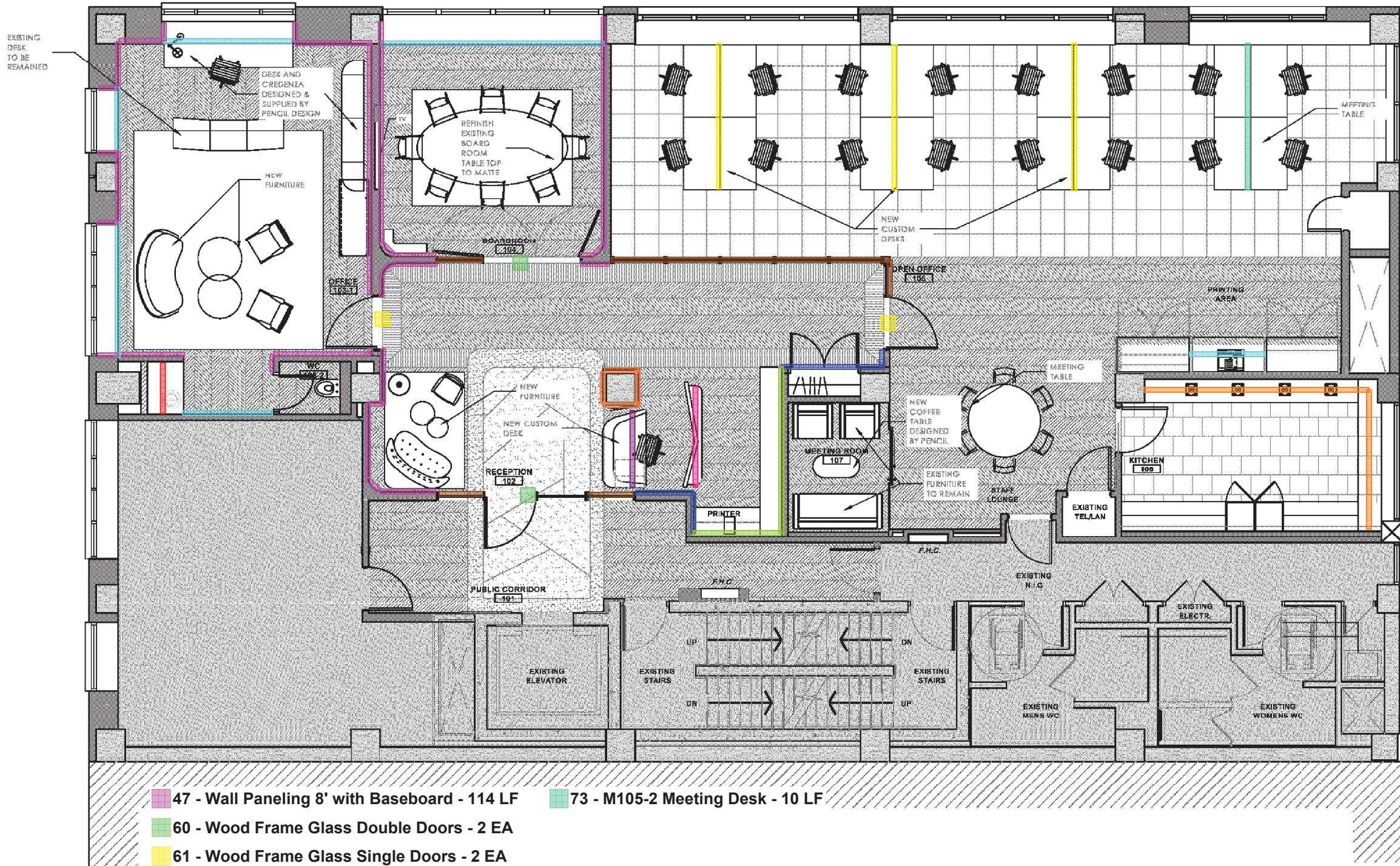

- 47 - Wall Paneling 8' with Baseboard - 114 LF
- 60 - Wood Frame Glass Double Doors - 2 EA
- 61 - Wood Frame Glass Single Doors - 2 EA
- 62 - Baseboard - 44 LF
- 63 - White Oak Panels - 15 LF
- 64 - Glass Wall Partition w/ Wood Frame - 31 LF
- 65 - Trader Desks - 30 LF
- 66 - M101-1 Reception Desk - 5 LF
- 67 - M101-2 Column Base Substructure - 9 LF
- 68 - M102-2 Screen - 7 LF
- 69 - M102-3 - 17 LF
- 70 - M103 Bar Counter - 4 LF
- 71 - M105 Print Station - 5 LF
- 73 - M105-2 Meeting Desk - 10 LF

PROJECT		TORONTO, ON	
CLIENT		MURCHINSON LTD	
TENDER	2020.11.24	00	
PRESENTATION	2020.10.18	00	
ISSUED FOR:	DATE:	REV.	
DRAWING TITLE: FURNITURE PLAN			
SCALE	1/8"=1'-0"		
PROJECT NO	107		